

CITY OF KELOWNA

BYLAW NO. 10764

Road Closure and Removal of Highway Dedication Bylaw
(Portion of Road South of Frost Road - adjacent to 1355 Steele Road)

A bylaw pursuant to Section 40 of the Community Charter to authorize the City to permanently close and remove the highway dedication of a portion of Road South of Frost Road

NOW THEREFORE, the Municipal Council of the City of Kelowna, in open meeting assembled, hereby enacts as follows:

1. That portion of highway attached as Schedule "A" comprising 112.4 m² shown in bold black as Road To Be Closed on the Reference Plan #EPP24126 prepared by Ferguson Land Surveying & Geomatics Ltd. and completed on 14th day of September, 2012, is hereby stopped up and closed to traffic and the highway dedication removed.
2. The Mayor and City Clerk of the City of Kelowna are hereby authorized to execute such conveyances, titles, survey plans, forms and other documents on behalf of the said City as may be necessary for the purposes aforesaid.

Read a first, second and third time by the Municipal Council this

Adopted by the Municipal Council of the City of Kelowna this

Mayor

City Clerk

Schedule "A"

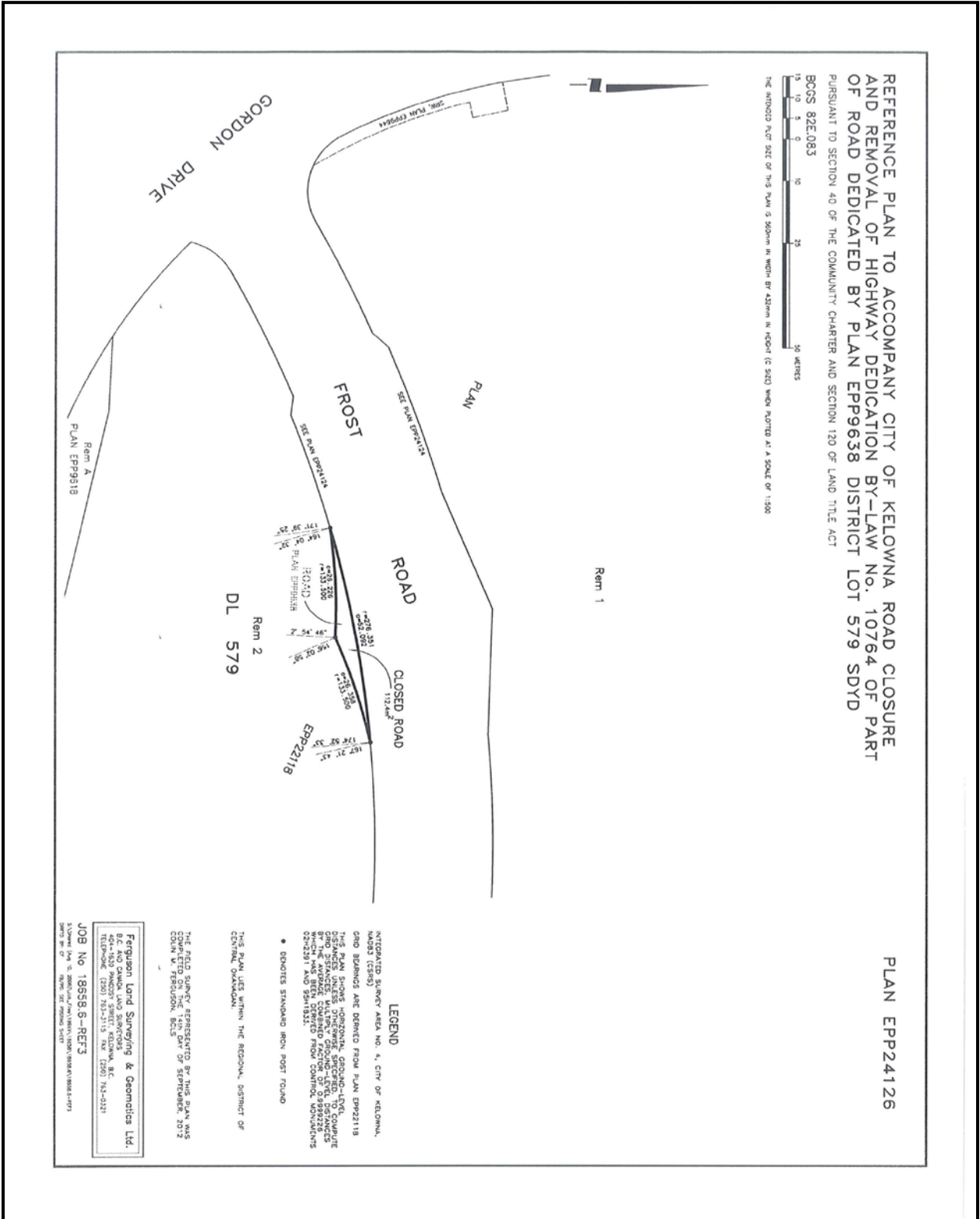

PLAN EPP24126

REFERENCE PLAN TO ACCOMPANY CITY OF KELOWNA ROAD CLOSURE AND REMOVAL OF HIGHWAY DEDICATION BY-LAW No. 10764 OF PART OF ROAD DEDICATED BY PLAN EPP9638 DISTRICT LOT 579 SDYD PURSUANT TO SECTION 40 OF THE COMMUNITY CHARTER AND SECTION 120 OF LAND TITLE ACT

BCCS 82E.083

10 METERS

THE ABOVE PLAN SIZE OF THIS PLAN IS 350mm WIDE BY 420mm HIGH (C SIZE) WHEN PLOTTED AT A SCALE OF 1:500

Rem 1

PLAN

ROAD

CLOSED ROAD

FROST

SEE PLAN EPP2118

DL 579

Rem 2

EPP22118

LEGEND

INTEGRATED SURVEY AREA NO. 4, CITY OF KELOWNA, MAJOR (CARS) AND BUILDINGS ARE DERIVED FROM PLAN EPP22118 THIS PLAN SHOWS HORIZONTAL, GROUND-LEVEL, BOUNDARY, ELEVATION, MULTI-LEVEL, DISTANCES FROM STATION, CURVE DATA, BEARING, DISTANCES BETWEEN POINTS, CURVE DATA, BEARING, DISTANCES 02+22.91 AND 95+19.31.

- DENOTES STANDARD IRON POST FOUND

THIS PLAN LIES WITHIN THE REGIONAL DISTRICT OF CENTRAL OKANAGAN.

THE FIELD SURVEY REPRESENTED BY THIS PLAN WAS COMPLETED ON THE 14th DAY OF SEPTEMBER, 2012 COLIN W. FERGUSON, BCLS

Ferguson Land Surveying & Geomatics Ltd.
 BC AND OAKDALE LAND SURVEYORS
 1000 WILSON AVENUE, SUITE 100
 OAKDALE, BC V2M 4K2
 TEL: (250) 753-2119 FAX: (250) 753-0121
 TEL: (250) 753-2119 FAX: (250) 753-0121
JOB No 186558.6-REF3
 SYSTEM PLAN No. 186558.6-REF3/186558.6-REF3
 DATE OF PLAN 18/09/2012